



JS PUMP

GS Series

GS Grinder Pumps

Textile effluent, tannery waste, pulp, small scale sewage systems, household sewage, garbage

The GS utilize a Hi Chromium grinder mechanism that performs a crushing and grinding action that leaves fabrics, leathers, rags and other soft solids as fine particles before discharging. Available with slide rail system to save maintenance cost and time.

Construction Material

- Hi Chromium grinder impeller and shredder ring.
- Double mechanical seals.(Sic/Car)
- Class F motor insulation.
- Shaft sleeve saves on shaft wear due to abrasives and corrosion.
- Additional lip seal protection keeps impurities and abrasives away from the mechanical seals.
- Thermal overload protection guards against high amperage and high temperature.
- Enhance cable entry sealing system.



NO.	DESCRIPTION	MATERIAL
01-2	CUSHION	NBR
01-3	STAND COVER	SUS 304
01-4	STAND SLEEVE	SUS 304
03	NUT	SUS 304
04	WASHER	SUS 304
05	IMPELLER	FCD 400
05W	GRINDER	HICR
05W-2	GRINDER RING	HICR
05W-3	GRINDER RING HOLDER	FCD 400
06	KEY	SUS 304
07	PUMP HOUSING	FCD 400
08	OIL CHAMBER COVER	FC 200
08-1	ORING	NBR
09	LIP SEAL (BOTTOM)	NBR
10	SHAFT SLEEVE	SUS 316
11	PLUGS	SUS 304
13	MECHANICAL SEAL	
13-2	SEAL COVER	SUS 304
14	BEARING (BOTTOM)	
14-2	BEARING COVER	SUS 304
16	MOTOR CASING	SUS 304
17	ROTOR SHAFT	SUS 304
18	STATOR	
20	BEARING (UP)	
21A	MOTOR BOTTOM COVER	FC 200
21A-1	ORING	NBR
23	OVERLOAD PROTECTOR	
26	UPPER COVER	FC 200
26-1	ORING	NBR
27	CABLE GLAND	
27-1	ORING	NBR
28	RUBBER SLEEVE	NBR
31	CABLE	PVC
34	HANDLE	SUS 304 + NBR
37	OIL	T-32
38E	ELBOW	FC 200
38E-1	GASKET	NBR
38F	FLANGE	FC 200
38F-1	GASKET	NBR

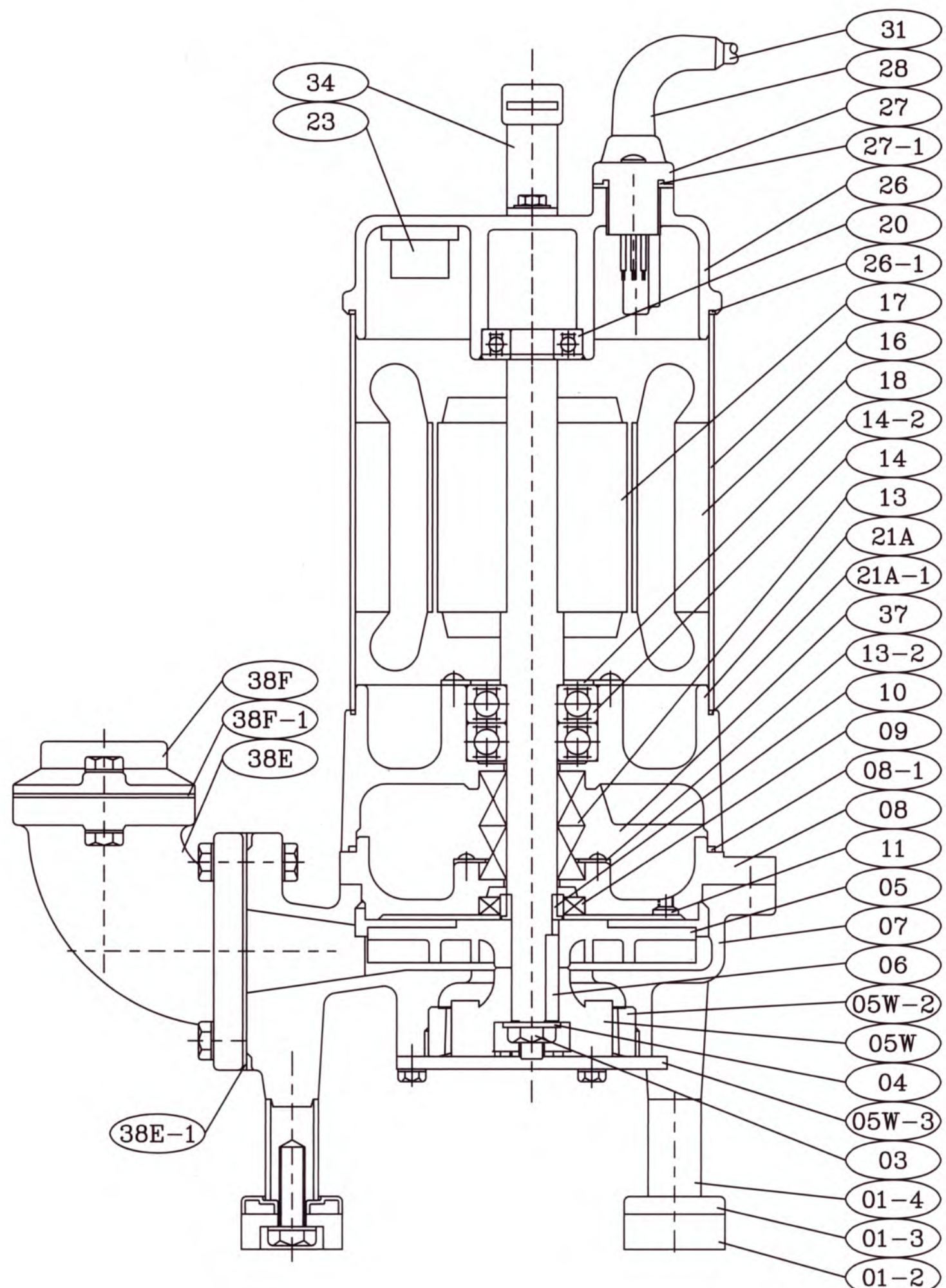

GS Performance Curve

50/60

Pump Type	Output KW	Output HP	Discharge Inch	Voltage	Max			Cable M	Weight kg
					Head M	Capacity L/min	Solid mm		
GS750	0.75	1	1 $\frac{1}{4}$	1 phase 100V-240V	16/16	190/190	3	10	25
GS1200	1.2	1.5	1 $\frac{1}{4}$		18/17	200/170	3	10	28
GS1500	1.5	2	1 $\frac{1}{4}$		22/23	220/180	3	10	31
GST8	0.75	1	1 $\frac{1}{4}$	3 phase 200V-600V	16/16	190/190	3	10	26
GST12	1.2	1.5	1 $\frac{1}{4}$		18/17	200/170	3	10	29
GST15	1.5	2	1 $\frac{1}{4}$		22/23	220/180	3	10	32
GST22	2.2	3	2		24/26	320/260	3	10	45
GST37	3.7	5	2		35/33	400/330	3	10	47

