



# UTILITY PUMPS

40-size UTILITY PUMP with 1" ports  
and AC electric motor

## Pump Model:

- **53041-2003-230** – 230 volt, 1 phase 50 Hz, 0.3kW (Continuous rated motor)
- **53041-2003-110** – 110 volt, 1 phase 50 Hz, 0.3kW (Continuous rated motor)
- **53041-2003-400** – 400 volt, 3 phase 50 Hz, 0.37kW (no handle)

\*Nitrile oil-resistant impeller fitted as standard.

\*Neoprene impeller versions available.

\*Also available: reduced flow versions for liquid viscosity up to 700cp. Check with your pump supplier.

## Specifications:

- Pump body: Bronze
- Shaft: AISI316 stainless steel
- Shaft seal: Mechanical (Carbon-ceramic)
- Maximum recommended liquid viscosity: 150cp
- Motor: 4 pole, totally enclosed, fan ventilated, IP55 enclosure. Single-phase motors fitted with manual reset thermal overload cut-out.
- Rapid self-priming up to 2 metres vertical lift.
- Handles hard and soft solids up to 4mm in size.
- Can pump up to 90% entrained air
- Up to 30 minutes dry running protection

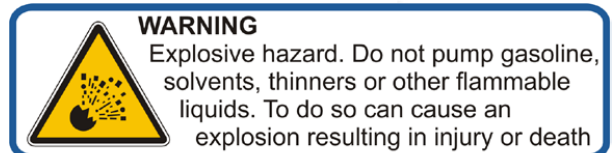
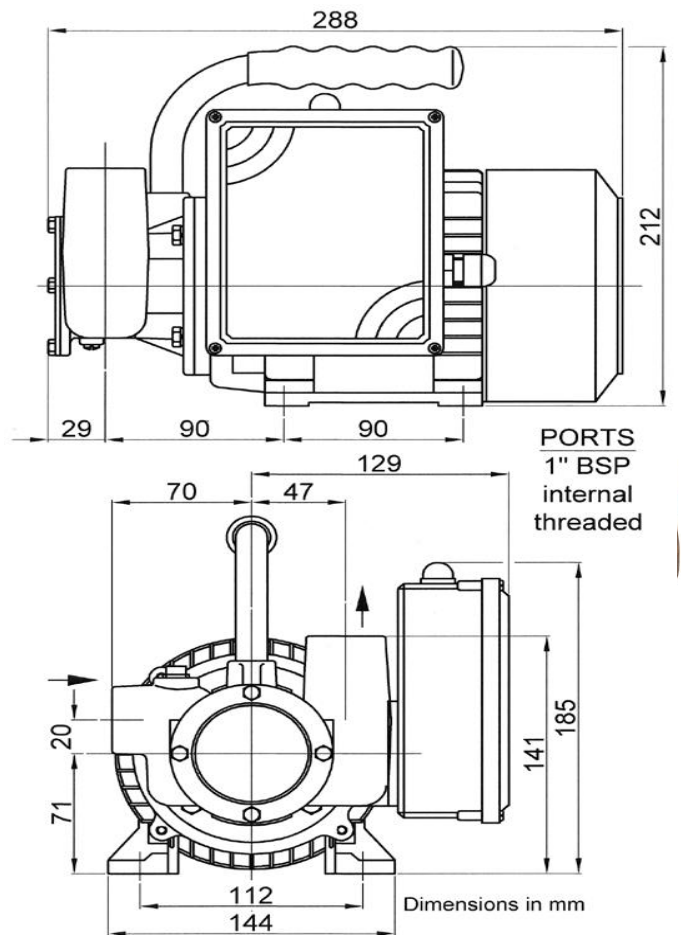

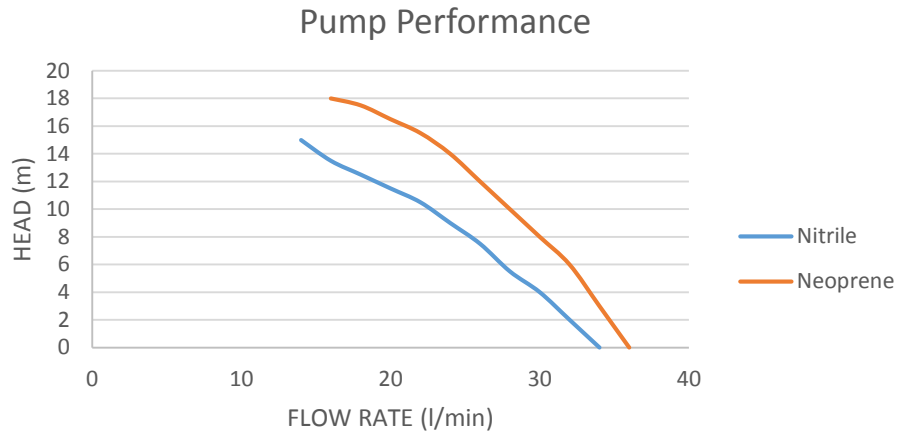

Performance figures are based on manufacturer's tests with water and are not guaranteed for any particular application. Product descriptions and specifications are subject to alteration without notice.

**Whisper Pumps**  
Leen Court  
Boughton  
Newark  
Nottinghamshire  
NG22 9ZD  
United Kingdom

Call us now: 01777 871100

[www.whisperpumps.com](http://www.whisperpumps.com)